

ST. JANE  
CHICAGO

THE TOWER  
AT ST. JANE



## Eclectic Spaces at St. Jane

From a beer barrel lined private dining room to a grand Art Deco inspired ballroom, there's no shortage of creative and flexible spaces at St. Jane. Effortless technology, eclectic menus and inspiring breaks complete the experience.

## Traditional Meeting Spaces

With soaring ceilings and Art Deco details, even our traditional meeting spaces are extraordinary.



### PREFUNCTION

The pre-function space features striking organic print wallpaper and plush furniture that sets a beautiful backdrop for meals, registration and exhibits.

### CARBIDE BALLROOM

Our largest space, the Carbide Ballroom, boasts a frosted palette of white on white, smoky ethereal drapes and sparkling

chandeliers on over 20-foot high ceilings. Utilize the whole room or divide it into three smaller spaces for events of up to 350.



### CARBON BALLROOM

Located on the 2nd floor with views of downtown Chicago and an abundance of natural light, the Carbon Ballroom can be divided

into five spaces and accommodate groups up to 260.

## Intimate and Significant

Smaller but still mighty, our collection of intimate meeting spaces plays host to groups and meeting breakouts from 10 to 100.



### GRANITE ROOM

Take advantage of the 40-foot outdoor terrace from the Granite Room for gatherings up to 100. With floor-to-ceiling glass windows and a neutral palette, our Michigan Avenue views will take center stage.

### MARBLE

Located on the fourth floor, this intimate room can be divided into two smaller spaces for groups up to 96.



### SAPPHIRE

The Sapphire Room on the fourth floor is the ideal spot for a board meeting with a cozy setting that accommodates up to ten.

### GOLD AND BRONZE

The Gold and Bronze rooms are two identical function spaces that seat 12-30 and can host as many as 40 for a reception or meeting break.

# The Non-Traditional

From our Art Deco lobby to a social club space to sprawling Presidential suites, we've got a spot for any creative gathering or celebratory event.



## ST. JANE LOBBY

Our Art Deco-inspired lobby is complete with a vintage fireplace, art filled bookshelves and statement floors. Jewel-toned furniture,

communal working table and vintage details provide the backdrop to mix and mingle while taking in our Michigan Avenue views.

## THE GATE

Named after Jane Addams' Hull House founding partner, Ellen Gates Starr, The Gate is a living and social space directly off our lobby inspired

by the spirit of innovation and collaboration. Host your meeting on a converted pool table while admiring the space's eclectic art.



## WOOD GRAIN @ FREE REIN

Our private dining space within Free Rein is adorned by Chicago's favorite local brewery barrels and features a farm-style table for intimate gatherings from 12-20.

## SUITE LIFE

With a total of 58 suites including two Presidentials that encompass an entire floor, the opportunities are endless for corporate and social gatherings alike in a residential setting.



## Eat + Drink

Cocktails and cuisine take center stage with our dining venues – from a contemporary brassiere to an authentic Jamaican lounge.



### FREE REIN

Situated on the doorstep of Michigan Avenue, next to St. Jane, Free Rein is an American brasserie celebrating Chicago's diverse food biography. Serving an all-day menu, our culinary

team embraces new school techniques with old world familiarities. The restaurant is perfect for large social outings or intimate business meals and features a lively bar and sun soaked café.

### CAFÉ @ FREE REIN

A light filled all-day coffee bar and café with floor-to-ceiling views is just the place to provide a pick-me-up, any time of day. The light and airy café vibe is complemented by sweet and savory items and gourmet coffees.



### MR. BROWN'S LOUNGE

Offering a totally different (and awesome) vibe, Mr. Brown's Lounge is a full-service authentic Jamaican restaurant that can accommodate up to 175. Mr. Brown's Lounge serves lunch,

dinner and late night menus plus a weekend Caribbean brunch. The space offers everything you love about Jamaica – the vibe, the food, the groove and the best jerk chicken in town.



# ST. JANE

CHICAGO

## THE TOWER AT ST. JANE

### 2nd floor capacities

Meeting Room	Dimensions	Sq. Ft.	Height Ft.
Carbide Prefunction	43x16	688	11
Carbide Ballroom	40x78	3120	20
Carbide A	40x31	1240	20
Carbide B	40x26	1040	20
Carbide C	40x21	840	20
Carbide Office	20x14	280	20
Carbon Prefunction	30x24	720	10
Carbon Ballroom	21x110	2310	10
Carbon A	21x19	399	10
Carbon B	21x19	399	10
Carbon C	21x19	399	10
Carbon D	21x19	399	10
Carbon E	21x34	714	10
Carbon Office	12x11	132	10

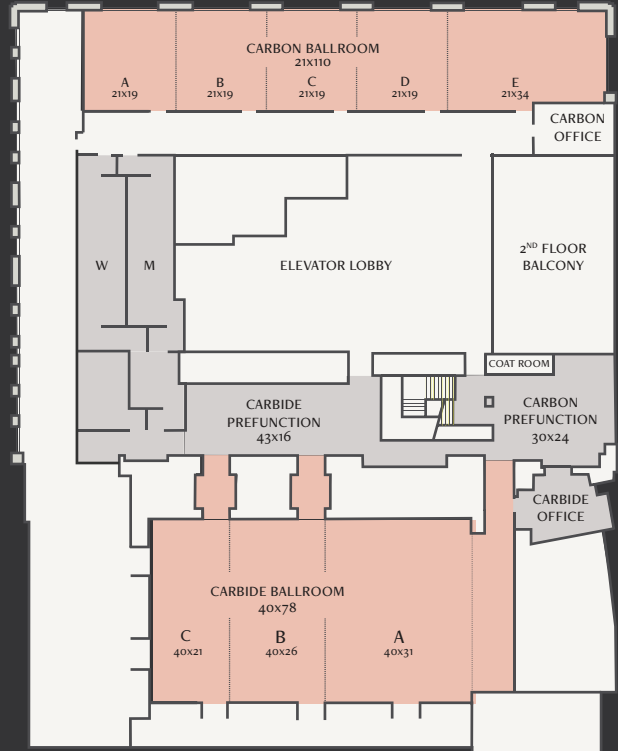

### 4th floor capacities

Meeting Room	Dimensions	Sq. Ft.	Height Ft.
Granite Prefunction	19x32	608	9.5
Granite	24x39	936	11.5
Granite A	24x22	528	11.5
Granite B	24x17	408	11.5
Sapphire	15x22	330	10
Gold	19x22	418	11.5
Bronze	19x21	399	11.5
Marble	21x44	924	11.5
Marble A	21x20	420	11.5
Marble B	21x24	504	11.5

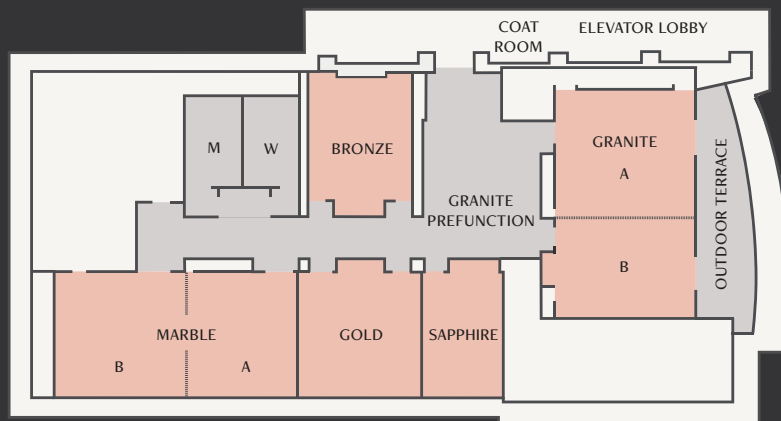

# ST. JANE

CHICAGO

## THE TOWER AT ST. JANE

### 2nd floor capacities

Meeting Room	Floor	Dimensions	Sq. Ft.	Height Ft.	Theatre	Conference	Reception	Classroom	U-Shape	Rounds	Crescent	Hollow Square
Carbide Prefunction	2	43x16	688	11	N/A	N/A	N/A	N/A	N/A	N/A	N/A	N/A
Carbide Ballroom	2	40x78	3120	20	336	70	350	150	69	300	144	84
Carbide A	2	40x31	1240	20	144	34	160	60	36	110	54	36
Carbide B	2	40x26	1040	20	160	34	180	63	39	120	72	42
Carbide C	2	40x21	840	20	120	34	140	42	36	80	48	36
Carbide Office	2	20x14	280	20	N/A	12	N/A	N/A	N/A	N/A	N/A	N/A
Carbon Prefunction	2	30x24	720	10	N/A	N/A	N/A	N/A	N/A	N/A	N/A	N/A
Carbon Ballroom	2	21x110	2310	10	240	100	260	126	96	220	120	102
Carbon A	2	21x19	399	10	60	16	60	18	18	40	24	18
Carbon B	2	21x19	399	10	60	16	60	18	18	40	24	18
Carbon C	2	21x19	399	10	60	16	60	18	18	40	24	18
Carbon D	2	21x19	399	10	60	16	60	18	18	40	24	18
Carbon E	2	21x34	714	10	90	28	90	36	24	60	36	30
Carbon Office	2	12x11	132	10	N/A	6	N/A	N/A	N/A	N/A	N/A	N/A

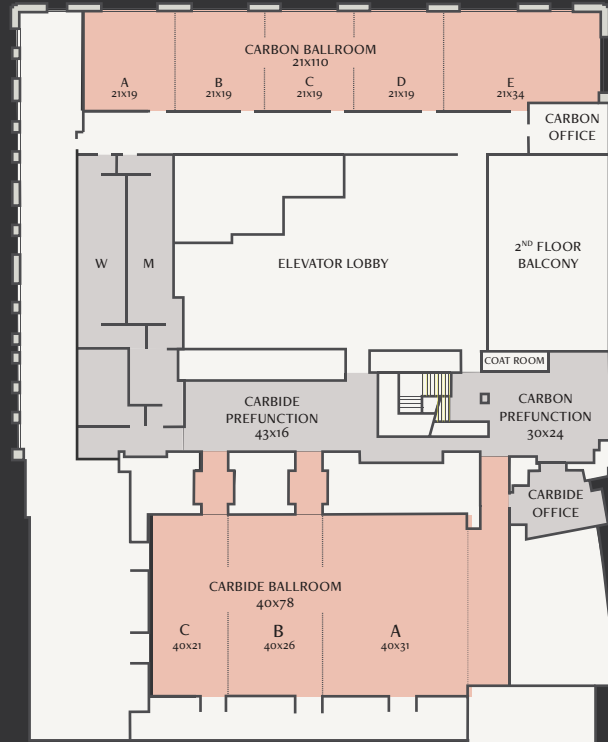

A PLACE TO COME TOGETHER.  
TO CONVERSE. TO COLLABORATE.

*4th floor capacities*

Meeting Room	Floor	Dimensions	Sq. Ft.	Height Ft.	Theatre	Conference	Reception	Classroom	U-Shape	Rounds	Crescent	Hollow Square
Granite Prefunction	4	19x32	608	9.5	N/A	N/A	N/A	N/A	N/A	N/A	N/A	N/A
Granite	4	24x39	936	11.5	100	28	100	36	15	70	30	18
Granite A	4	24x22	528	11.5	45	28	45	24	15	30	18	18
Granite B	4	24x17	408	11.5	35	18	35	12	15	20	12	18
Sapphire	4	15x22	330	10	N/A	10	N/A	N/A	N/A	N/A	N/A	N/A
Gold	4	19x22	418	11.5	40	16	40	18	15	30	18	12
Bronze	4	19x21	399	11.5	40	16	40	18	15	30	18	12
Marble	4	21x44	924	11.5	96	24	96	36	30	80	48	36
Marble A	4	21x20	420	11.5	40	16	40	18	15	30	18	18
Marble B	4	21x24	504	11.5	50	16	50	24	15	40	24	18

